

# 600 WEST BROADWAY SUITE 3000

SAN DIEGO, CA 92101



OFFICE SUBLEASE | AVAILABLE WITHIN 30 DAYS

**15,362 RSF**

HUGHESMARINO

# BUILDING INFORMATION



## **BUILDING**

One America Plaza

## **ADDRESS**

600 West Broadway,  
Suite 3000,  
San Diego, CA 92101

## **AVAILABLE**

Within 30 Days

## **ASKING RATE**

Negotiable

## **AVAILABLE THROUGH**

August 30, 2027

## **ADDITIONAL FEATURES**

- One of a kind plug-in-play office available on the 30th floor at One America! Features include a largely open floor plan with ample meeting space and four incredible patios with views of the Bay, Coronado Bridge, Museum of Man, and as far as UTC!
- Available furnished or unfurnished
- Available as a full floor or partial floor
- Onsite dining and beverage options
- Meeting and Event Space: State of the art conference center featuring a 65-seat auditorium

# LOCATION HIGHLIGHTS

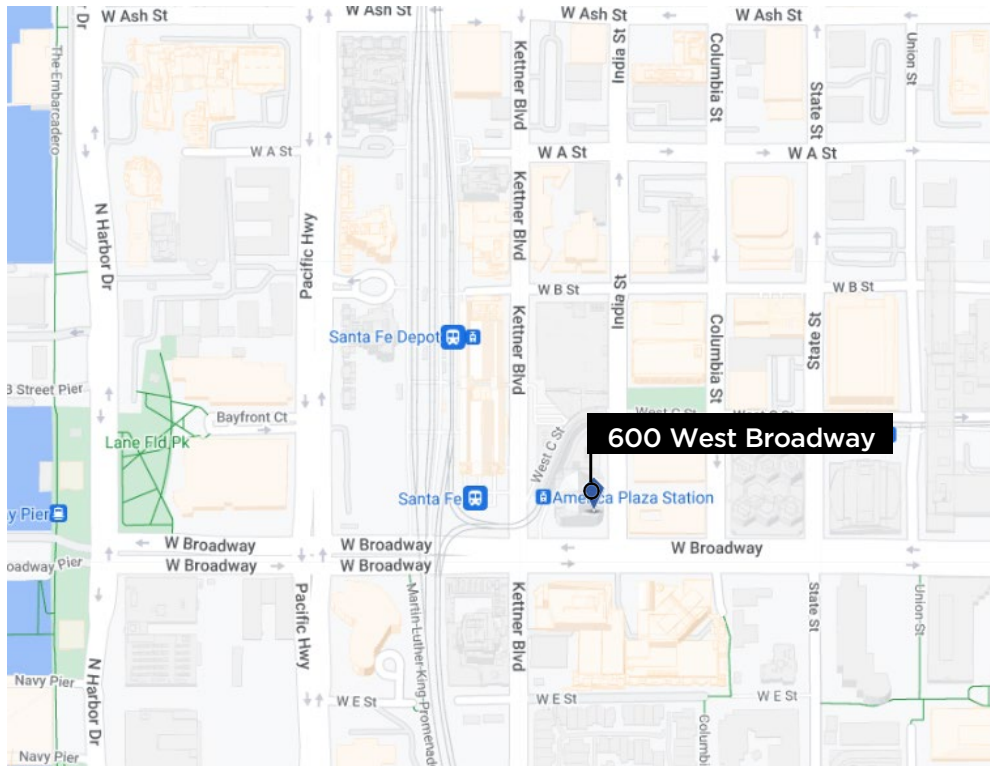

**TRANSIT  
SCORE**

**83**

**WALK  
SCORE**

**98**

## KEY HIGHLIGHTS

- Convenient options for freeway access, Coaster and Trolley station.
- Walking distance to Little Italy, Petco Park, Gaslamp Quarter and Marina District



# FLOOR PLAN

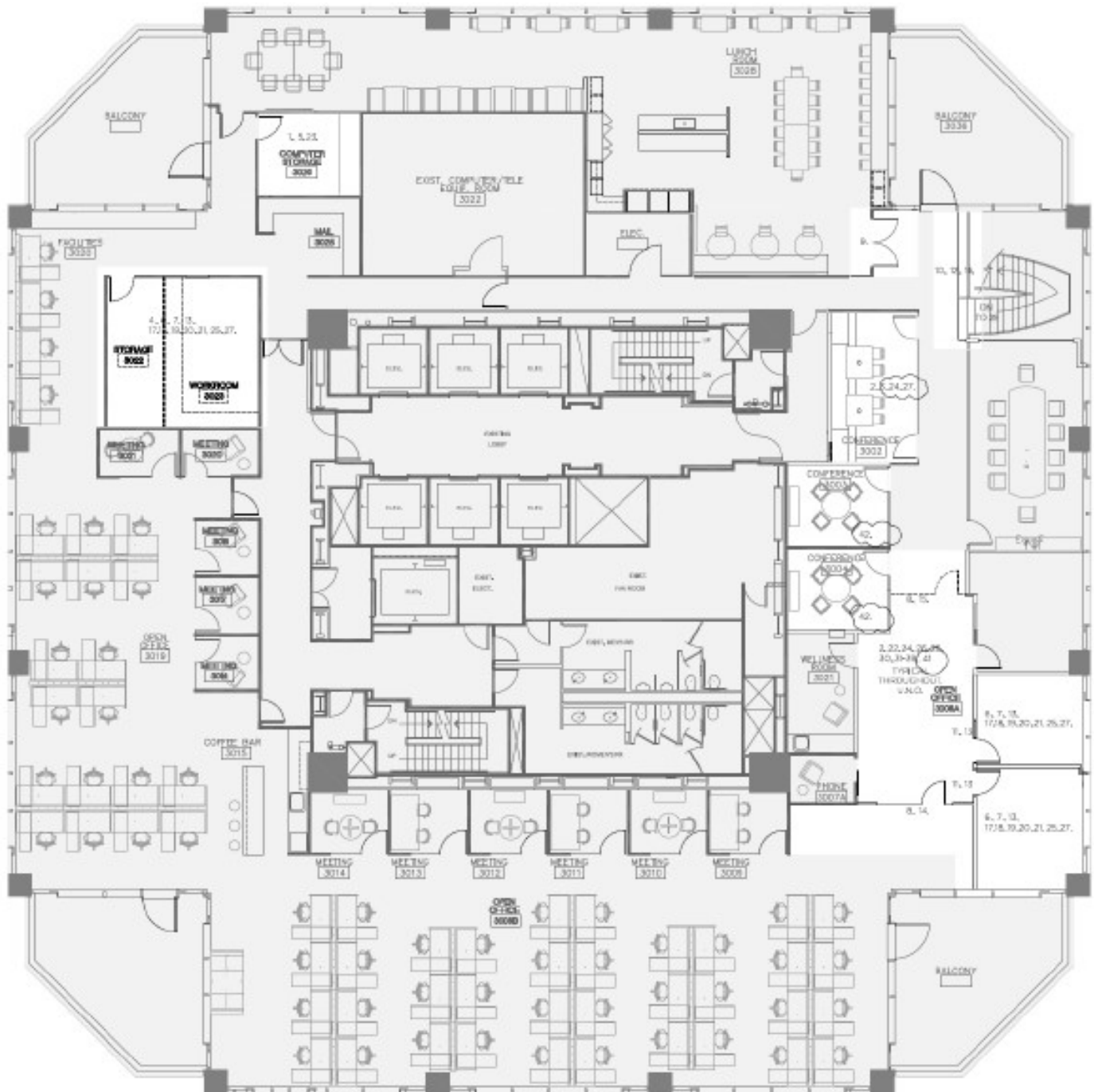

600 WEST BROADWAY, SUITE 3000





600 WEST BROADWAY, SUITE 3000





600 WEST BROADWAY, SUITE 3000





600 WEST BROADWAY, SUITE 3000





600 WEST BROADWAY, SUITE 3000





600 WEST BROADWAY, SUITE 3000





# CONTACT INFORMATION



**STAR HUGHES-GORUP**

[hughes@hughesmarino.com](mailto:hughes@hughesmarino.com)

619.238.2111

Broker Lic. #01907998

**1450 FRONT STREET  
SAN DIEGO, CA 92101**

619.238.2111 | [hughesmarino.com](http://hughesmarino.com)

**HUGHESMARINO**