

402 WEST BROADWAY SUITE 2300

San Diego, CA 92101



OFFICE SUBLEASE | AVAILABLE IMMEDIATELY

10,889 RSF

BUILDING INFORMATION

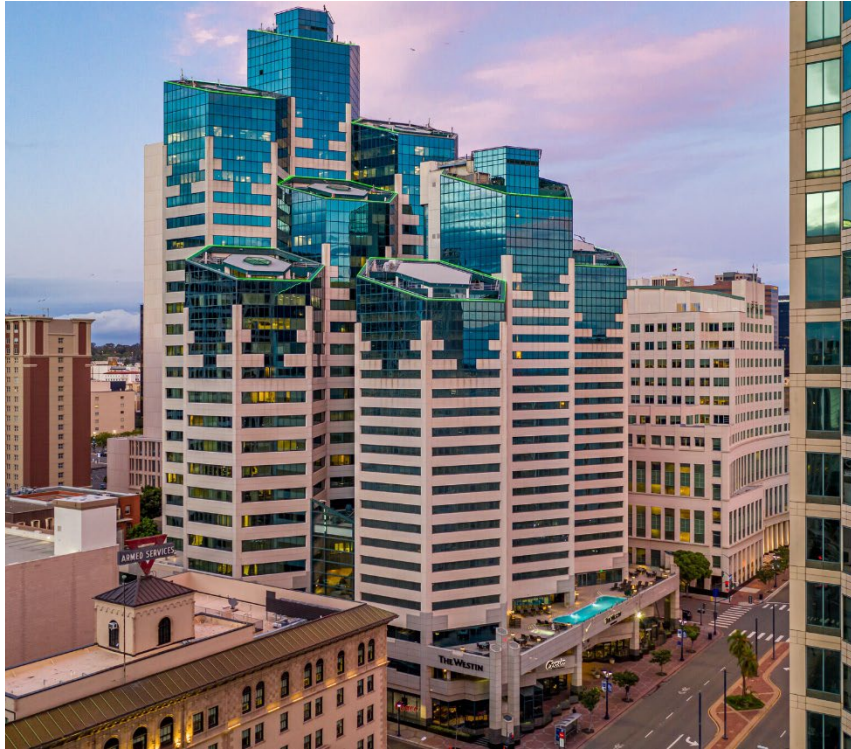

BUILDING

Emerald Plaza

ADDRESS

402 West Broadway,
Suite 2300,
San Diego, CA 92101

AVAILABLE

Immediately

ASKING RATE

\$2.25 per RSF

TERM

Through October 31st, 2025

ADDITIONAL FEATURES

- Beautiful top-of-the-line sublease available in Emerald Plaza
- Panoramic bay and city views
- Private elevator lobby
- Unique opportunity to lease a full floor at less than 11,000 RSF
- High-end finishes including marble reception floors, glass offices and conference rooms, and abundant natural light

LOCATION HIGHLIGHTS

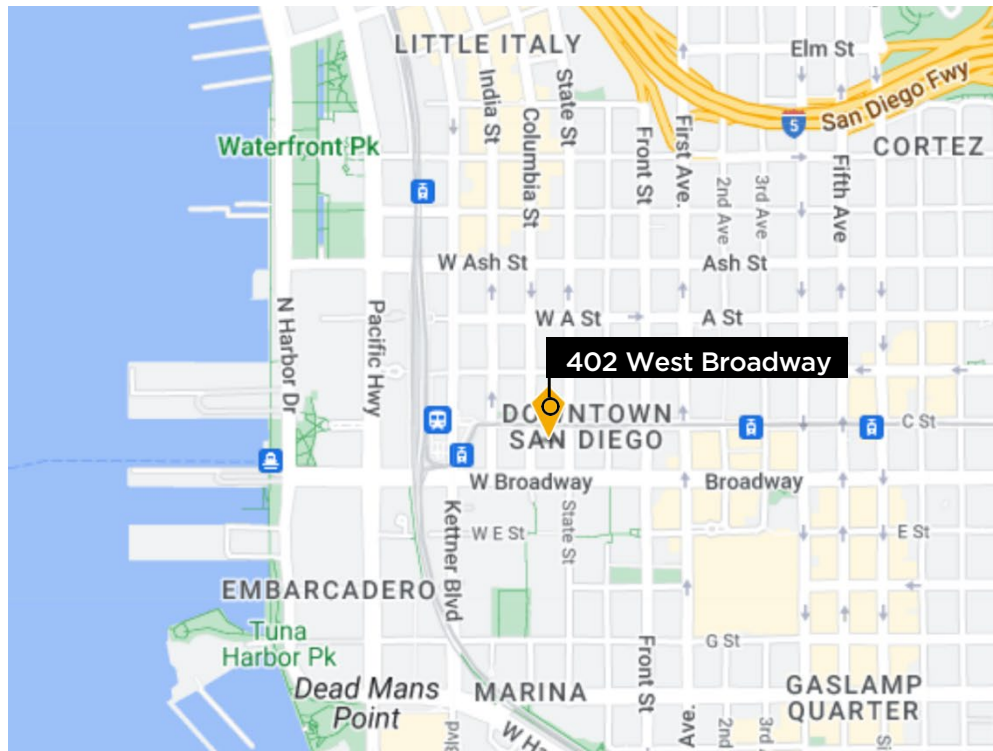

TRANSIT
SCORE

82

WALK
SCORE

98

KEY HIGHLIGHTS

- Excellent I-5 and CA-163 access and visibility
- Abundant Retail, Restaurant & Health Club Amenities
- Walking distance to Little Italy and Gaslamp

FLOOR PLAN



402 WEST BROADWAY, SUITE 2300



402 WEST BROADWAY, SUITE 2300



402 WEST BROADWAY, SUITE 2300



402 WEST BROADWAY, SUITE 2300



402 WEST BROADWAY, SUITE 2300



CONTACT INFORMATION

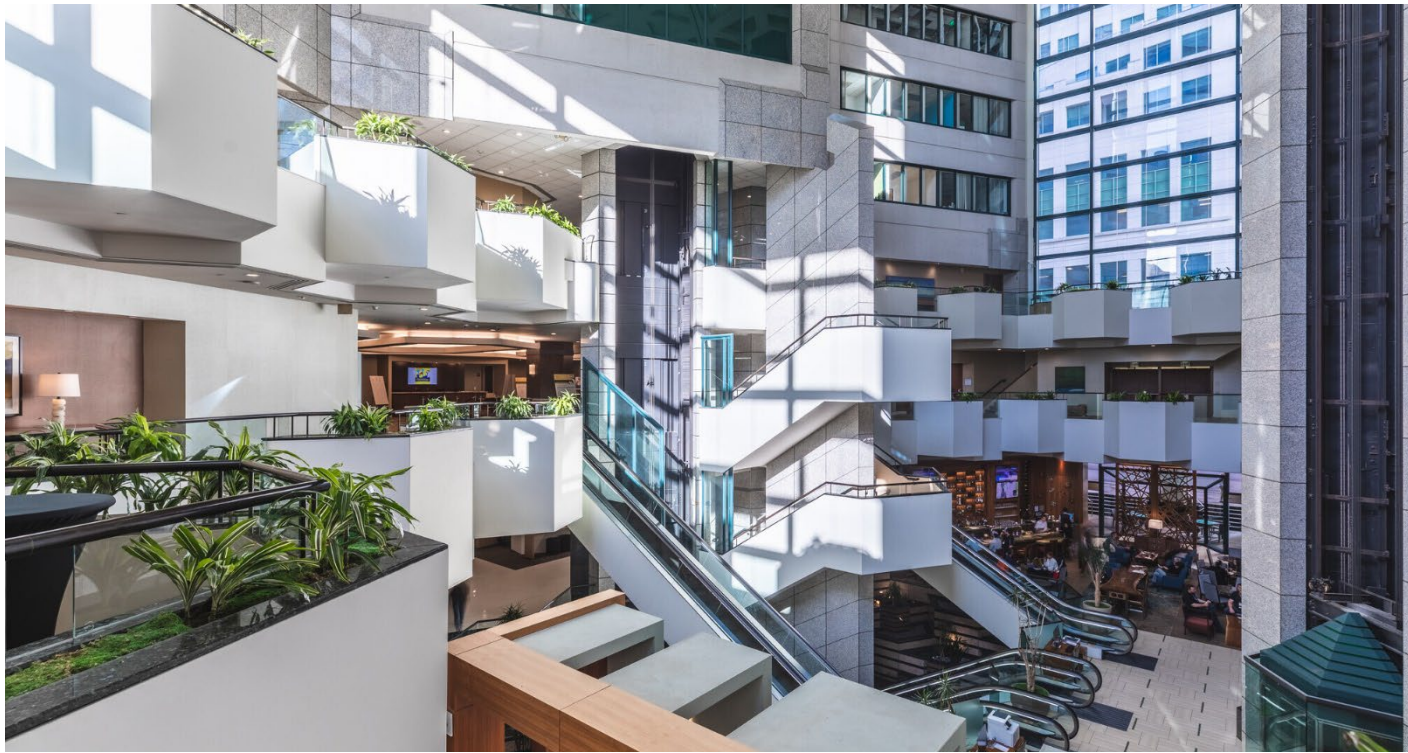

STAR HUGHES-GORUP

Executive Vice President & Director
hughes@hughesmarino.com
619.238.2111
Broker Lic. #01907998



CALE MILLER

Senior Vice President
cale@hughesmarino.com
415.431.3211
Broker Lic. #01714837

1450 FRONT STREET, SAN DIEGO, CA 92101
619.238.2111 | hughesmarino.com

HUGHESMARINO