

# 401 WEST A STREET SUITE 1430

SAN DIEGO, CA 92101



OFFICE SUBLEASE | AVAILABLE NOW

3,227 RSF

HUGHES MARINO

# BUILDING INFORMATION



## **BUILDING**

1 Columbia Place

## **ADDRESS**

401 West A Street,  
Suite 1430,  
San Diego, CA 92101

## **AVAILABLE**

Now

## **ASKING RATE**

\$2.50 per SF

## **AVAILABLE THROUGH**

September 30, 2027

## **ADDITIONAL FEATURES**

- Class A law office suite available for sublease at 1 Columbia Place! Space includes five private offices with a conference room, break area and double-door entry off the elevator lobby.



# LOCATION HIGHLIGHTS

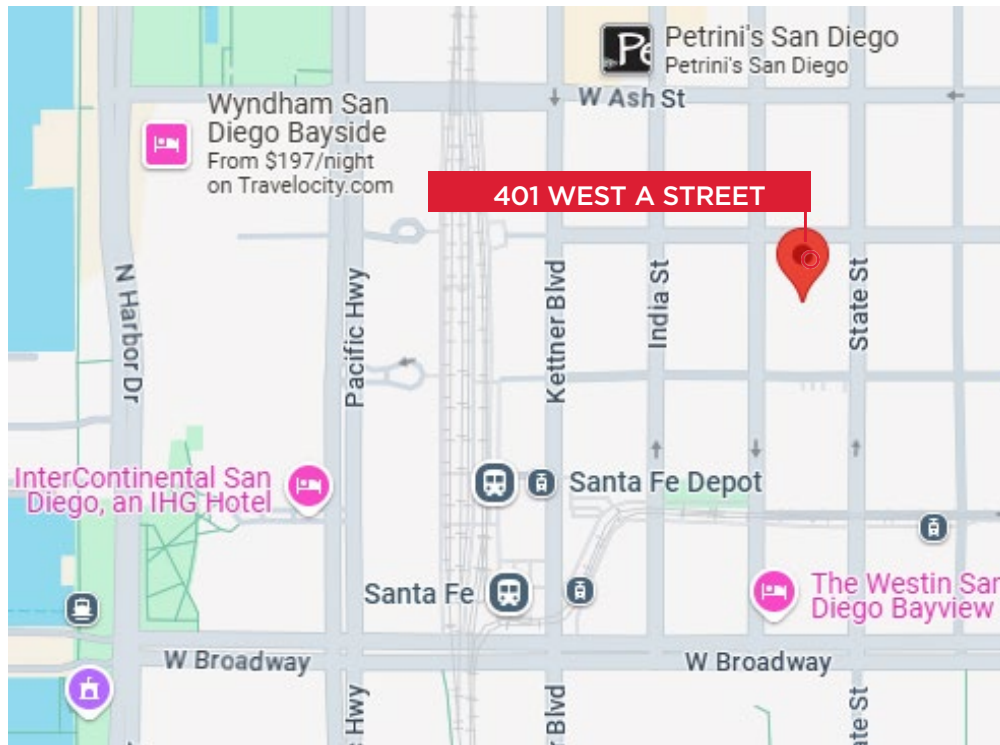

## **FREEWAY ACCESS**



## **RETAIL & RESTAURANTS**



## **HEALTH CLUB**



## **KEY HIGHLIGHTS**

- Excellent I-5 and CA-163 access and visibility
- Walking distance to Downtown train and trolley stops
- Abundant Retail, Restaurant & Health Club Amenities
- Highly desirable location in Downtown San Diego near Little Italy and the waterfront

# FLOOR PLAN

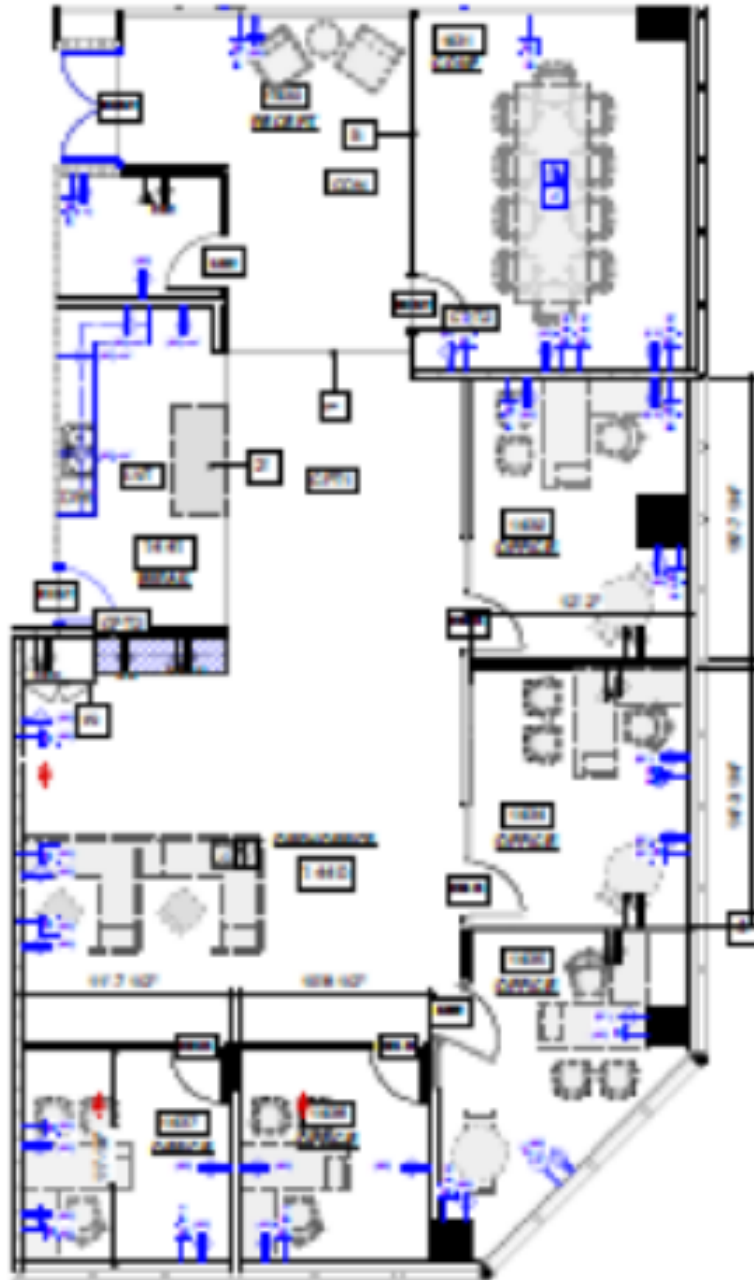

401 WEST A STREET, SUITE 1430





401 WEST A STREET, SUITE 1430



# CONTACT INFORMATION



**STAR HUGHES-GORUP**

[hughesmarino.com](mailto:hughesmarino.com)

(619) 238-2111

Broker Lic. #01907998

**1450 FRONT STREET, SAN DIEGO**  
619.238.2111 | [hughesmarino.com](http://hughesmarino.com)

**HUGHES**MARINO