

401 WEST A STREET SUITE 1430

SAN DIEGO, CA 92101



OFFICE SUBLEASE | AVAILABLE NOW

3,227 RSF

HUGHESMARINO

BUILDING INFORMATION



BUILDING

1 Columbia Place

ADDRESS

401 West A Street,
Suite 1430,
San Diego, CA 92101

AVAILABLE

Now

ASKING RATE

\$2.30 per SF

AVAILABLE THROUGH

September 30, 2027

ADDITIONAL FEATURES

- Conference Room
- Reception/Corporate Entrance
- Open Office
- 2 Private Offices

LOCATION HIGHLIGHTS

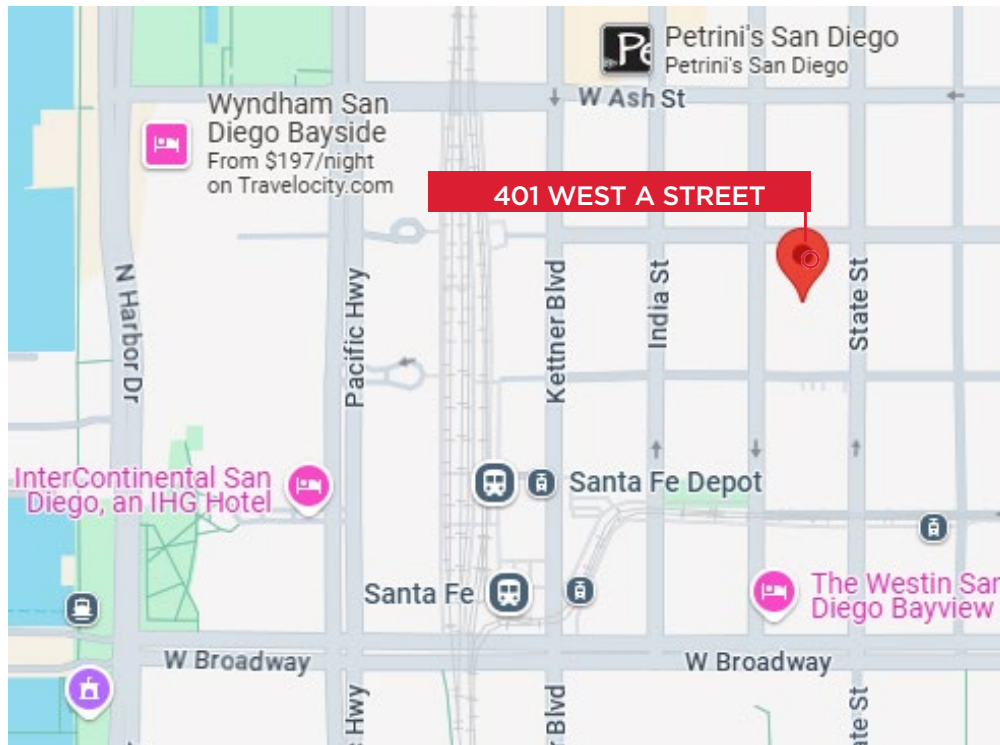

FREEWAY ACCESS



RETAIL & RESTAURANTS



HEALTH CLUB



KEY HIGHLIGHTS

- Excellent I-5 and CA-163 access and visibility
- Walking distance to Downtown train and trolley stops
- Abundant Retail, Restaurant & Health Club Amenities
- Highly desirable location in Downtown San Diego near Little Italy and the waterfront

FLOOR PLAN

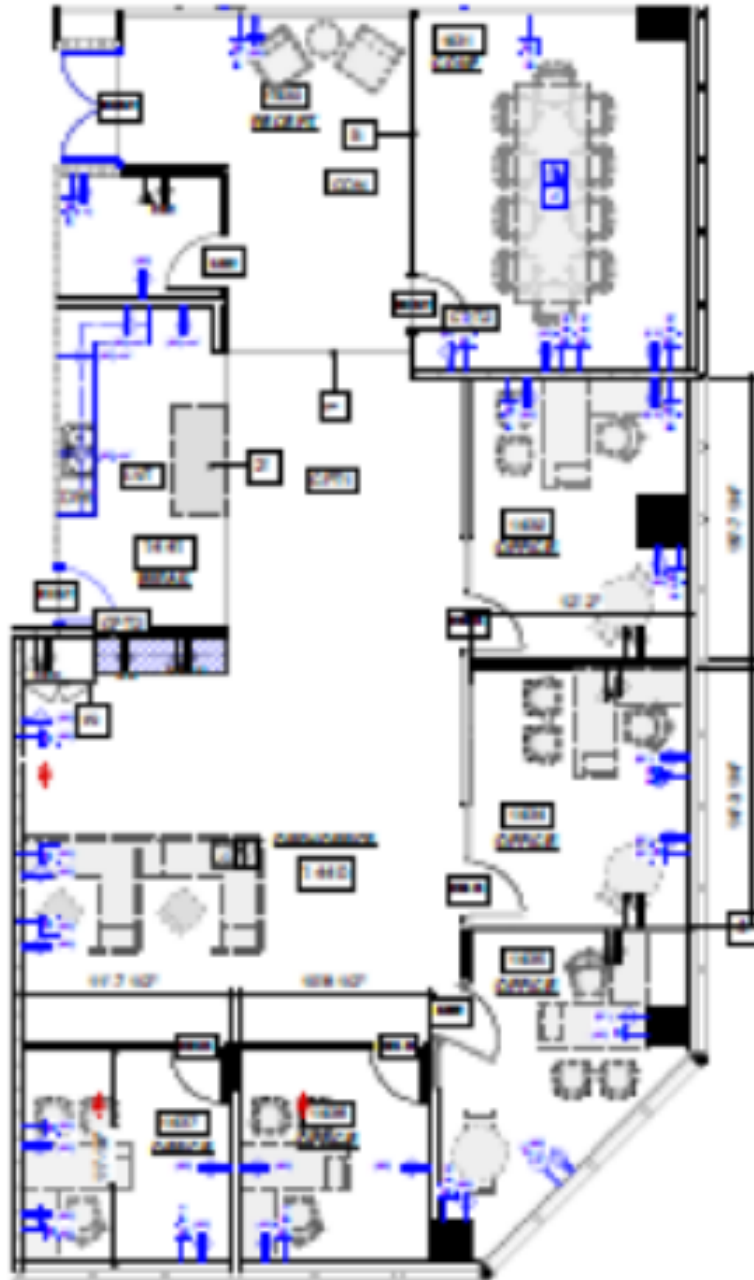

401 WEST A SREET, SUITE 1430



401 WEST A SREET, SUITE 1430



CONTACT INFORMATION



STAR HUGHES-GORUP

hughsteam@hughesmarino.com

(619) 238-2111

Broker Lic. #01907998

1450 FRONT STREET, SAN DIEGO
619.238.2111 | hughesmarino.com

HUGHESMARINO