

401 B Street **SUITE 2010**

San Diego, CA 92101



OFFICE SUBLEASE | AVAILABLE IMMEDIATELY

150-900 RSF

STAR HUGHES-GORUP | Executive Vice President & Director
619.238.2111 | hughsteam@hughesmarino.com

HUGHESMARINO

BUILDING INFORMATION



BUILDING

Wells Fargo Plaza

ADDRESS

401 B Street, Suite 2010,
San Diego, CA 92101

AVAILABLE

Immediately

ASKING RATE

\$1,200-\$1,500 per Office

AVAILABLE THROUGH

Flexible

ADDITIONAL FEATURES

- 4 window offices and 2 interior offices available for sublease in a law firm suite at Wells Fargo Plaza!

LOCATION HIGHLIGHTS

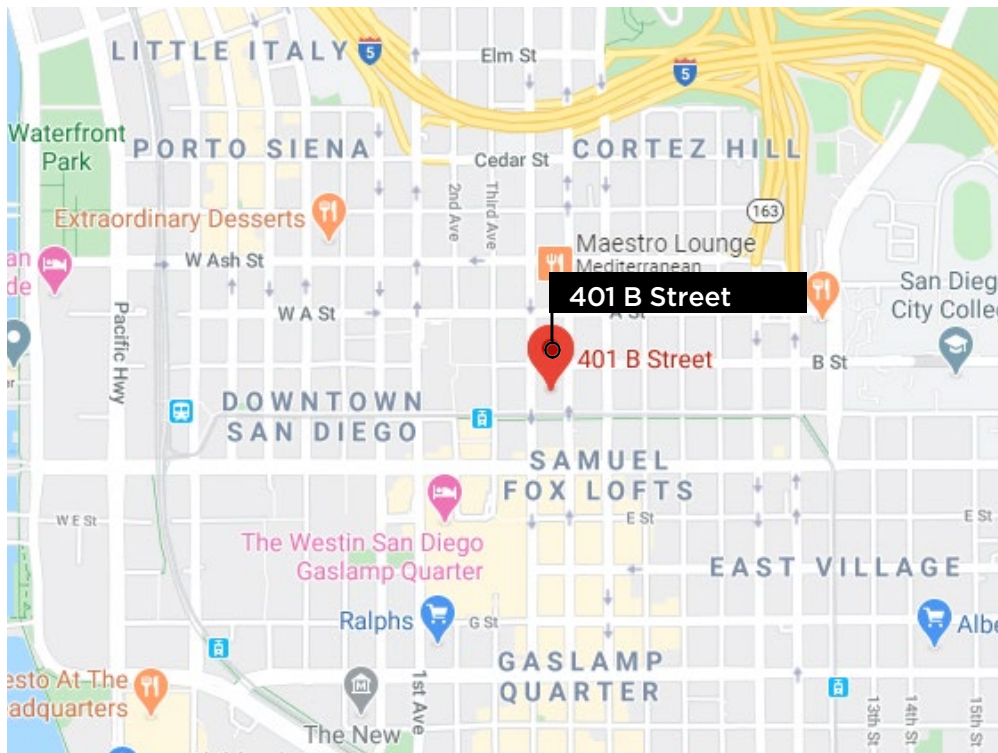

TRANSIT
SCORE

83

WALK
SCORE

100

KEY HIGHLIGHTS

- Excellent I-5 and CA-163 access and visibility
- Abundant Retail, Restaurant & Health Club Amenities

FLOOR PLAN

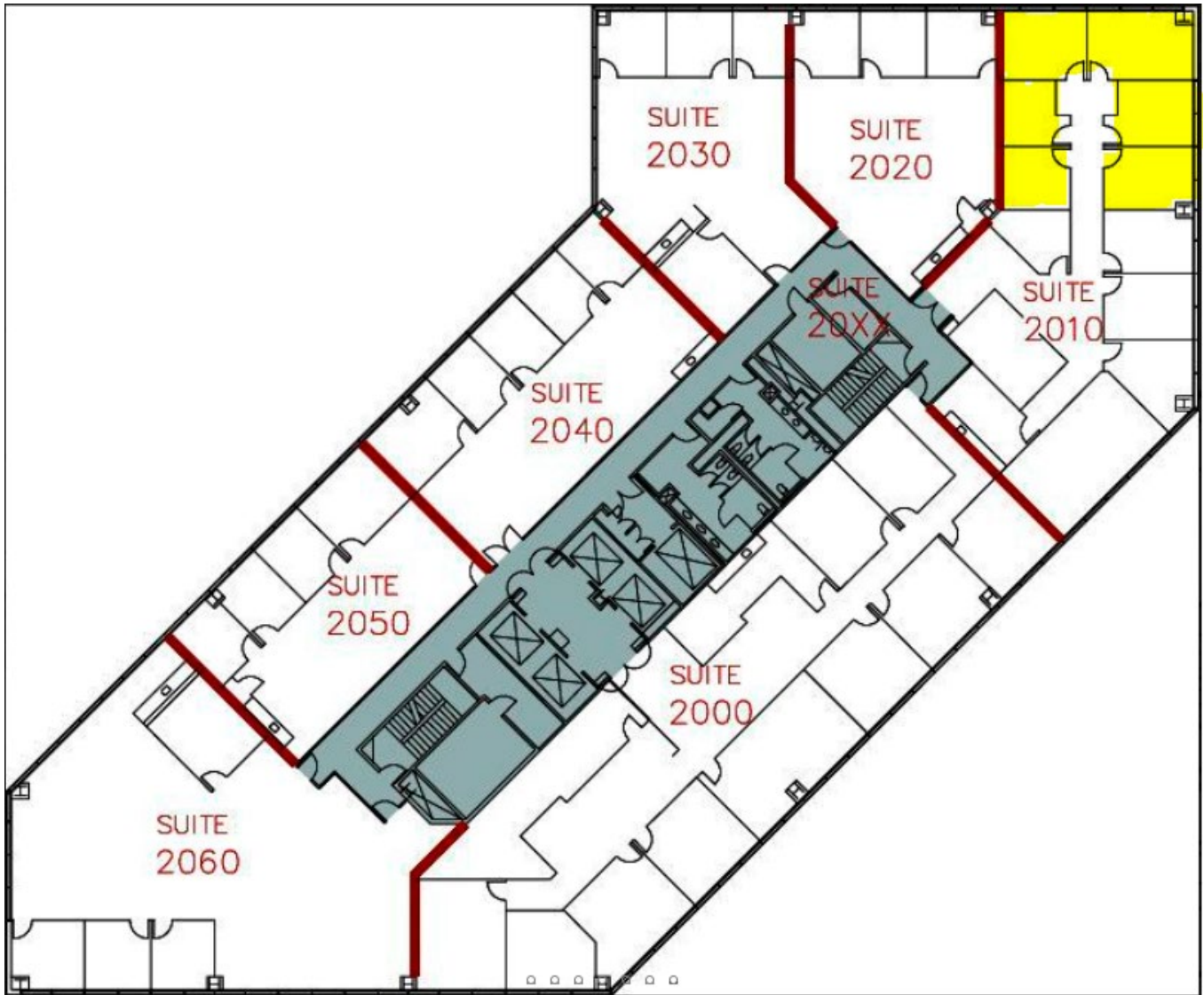

401 B STREET, SUITE 2010



STAR HUGHES-GORUP | Executive Vice President & Director
619.238.2111 | hughesteam@hugesmarino.com

HUGHESMARINO

401 B STREET, SUITE 2010



CONTACT INFORMATION



STAR HUGHES-GORUP
hughesmarino.com
619.238.2111
Broker Lic. #01907998

1450 FRONT STREET, SAN DIEGO, CA 92101
619.238.2111 | hughesmarino.com

HUGHESMARINO