

27450 Ynez Road **SUITE 203**

Temecula, CA 92591



OFFICE SUBLEASE | AVAILABLE WITHIN 30 DAYS

2,394 RSF

STAR HUGHES-GORUP | Senior Vice President & Director
619.238.2111 | hughesmarino.com

HUGHESMARINO

BUILDING INFORMATION



BUILDING

Temecula Corporate
Plaza Center

ADDRESS

27450 Ynez Road,
Suite 203,
Temecula, CA 92591

AVAILABLE

Within 30 Days

ASKING RATE

\$1.75 per RSF

TERM

Flexible, available through
January 2024

ADDITIONAL FEATURES

- High-end bank or professional service space available for sublease
- 5 private offices, 8 large workstations, and a large conference room
- Available furnished or unfurnished

LOCATION HIGHLIGHTS



TRANSIT
SCORE

19

WALK
SCORE

77

KEY HIGHLIGHTS

- Excellent I-15 access
- Central location with a variety of retail and restaurant options within walking distance

FLOOR PLAN

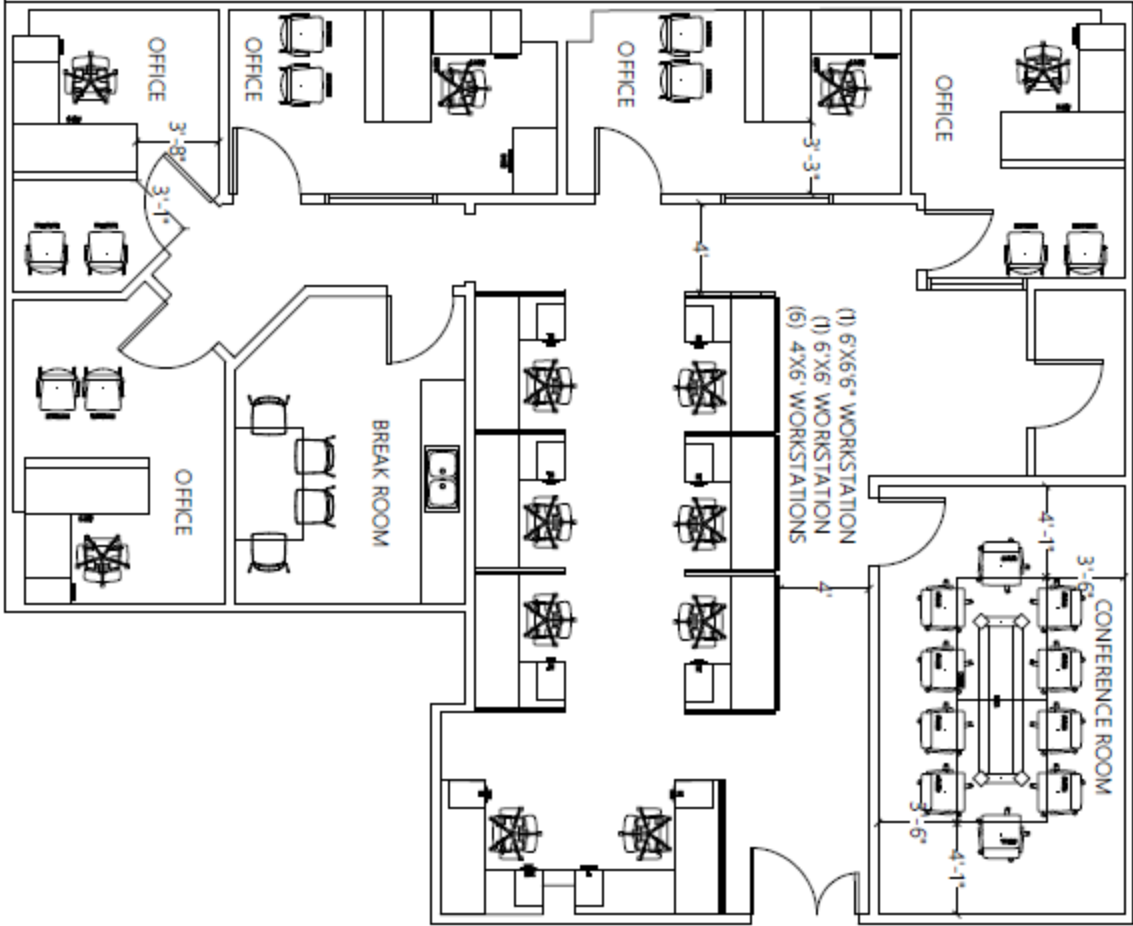

27450 YNEZ ROAD, SUITE 203



STAR HUGHES-GORUP | Senior Vice President & Director
619.238.2111 | hughsteam@hughesmarino.com

HUGHES MARINO

CONTACT INFORMATION



STAR HUGHES-GORUP
hughsteam@hughesmarino.com
619.238.2111
Broker Lic. #01907998

1450 FRONT STREET, SAN DIEGO, CA 92101
619.238.2111 | hughesmarino.com

HUGHES MARINO