

11568 Sorrento Valley Road

San Diego, CA 92121



LAB SUBLEASE | VACANT, AVAILABLE NOW

10,565 RSF (divisible)

SCOT GINSBURG

Executive Managing Director

Broker License. #01300321

858.344.5000

scot.ginsburg@hughesmarino.com

HUGHESMARINO

BUILDING INFORMATION



ADDRESS

SOVA SCIENCE DISTRICT

11568 Sorrento Valley Road
San Diego, CA 92121

AVAILABLE

Vacant, available now

ASKING RATE

\$3.25/SF/MO + Operating Costs

Operating Costs = \$1.18/SF/MO

TERM

Flexible through June 2026

ADDITIONAL FEATURES

- Office space: 1 lobby/reception, 1 break room, 1 conference room, 2 private offices, 19 cubicles on first floor, 14 cubicles on mezzanine
- Lab space: 4 rows of 32 benches, 3 private labs, 4 shared equipment area

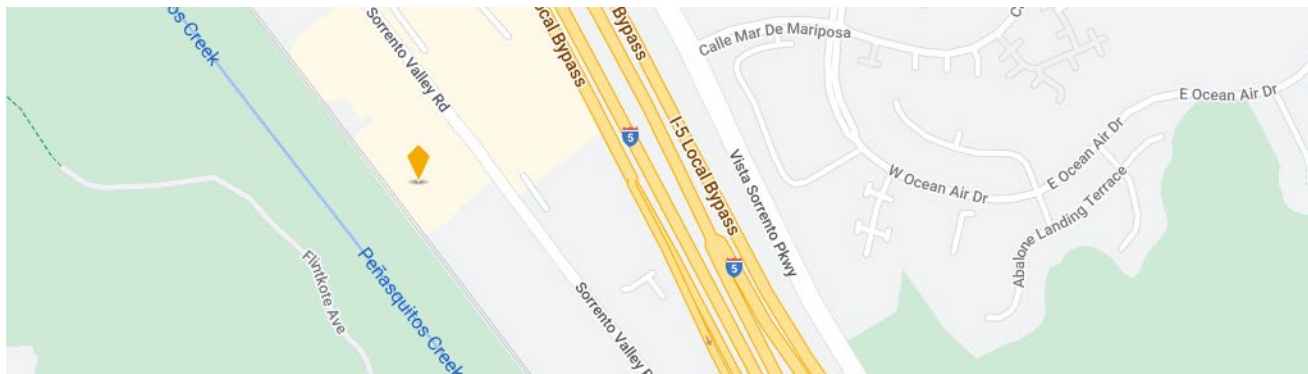

BUILDING AMENITIES

Elevate Balance

- Fitness & Yoga Classes
- Wellness Events & Workshops
- Walking And Running Trails

Elevate Brainpower

- Lunch & Learn Workshops
- Biotech Conferences
- Brain Health Clinics
- Fully Equipped Meeting Spaces

Elevate Play

- Tenant Competitions & Prizes
- Outdoor Gaming
- Adopt a Puppy Event

Elevate Connections

- Networking & Happy Hours
- Seasonal Events
- New Tenant Welcome Tours & Gifts

Elevate Generosity

- Donation Collections
- E-Waste Recycling
- Blood Drives

Elevate Taste

- Coffee Classes
- Rotating Food Trucks
- Beer & Wine Tastings

FLOOR PLAN

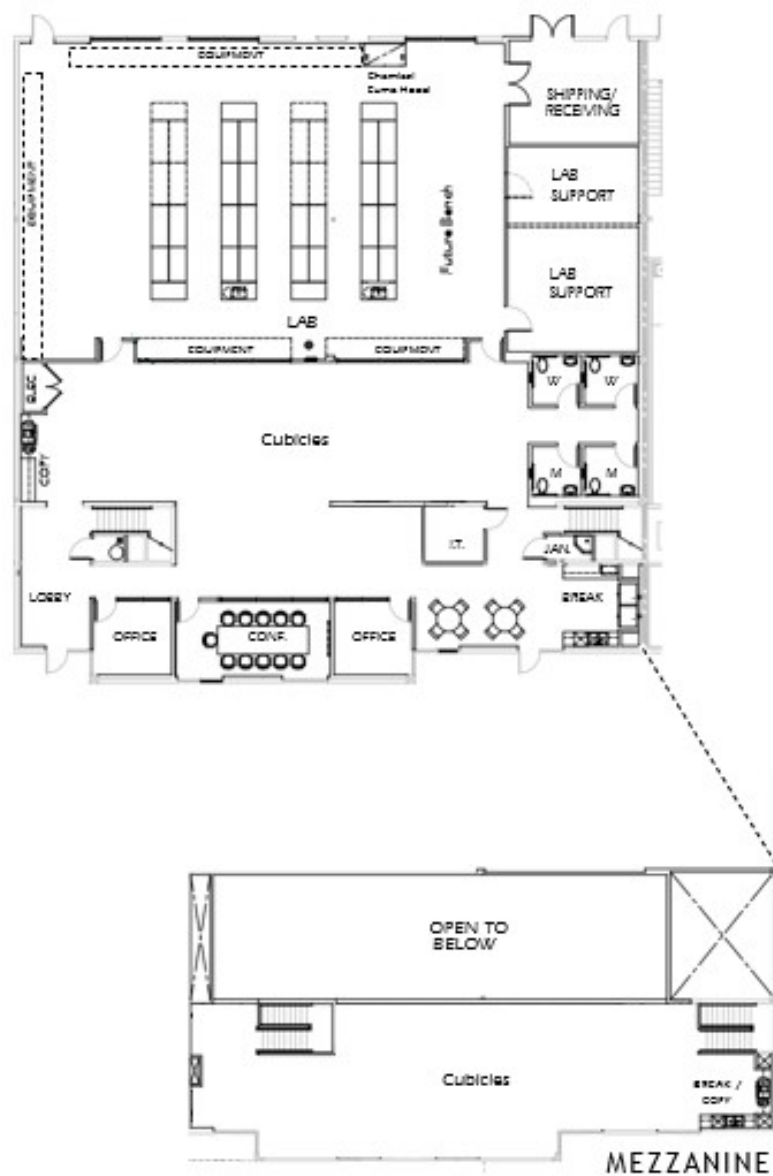

11568 Sorrento Valley Road



11568 Sorrento Valley Road



11568 Sorrento Valley Road

