

110 WEST A STREET SUITE 1200

San Diego, CA 92101



OFFICE SUBLEASE | AVAILABLE IMMEDIATELY

200 – 3,000 RSF

STAR HUGHES-GORUP | Senior Vice President & Director
619.238.2111 | hughessteam@hughesmarino.com

HUGHESMARINO

BUILDING INFORMATION



BUILDING

One Ten Plaza

ADDRESS

110 West A Street
San Diego, CA 92101

AVAILABLE

Immediately

ASKING RATE

\$400 per workstation
\$1,000-\$1,500 per private office
\$2.50/RSF for standalone suite

AVAILABLE THROUGH

June 30, 2025

ADDITIONAL FEATURES

- One-of-a-kind sublease on the 12th floor of One Ten Plaza with views towards Balboa Park
- Central location with easy freeway access, and walking distance to Little Italy and court!
- Opportunity to sublease between 1 and 7 private offices with potential for a private entrance, conference room, kitchen, and storage area
- Pricing and term are flexible depending on the subtenant needs

STAR HUGHES-GORUP | Senior Vice President & Director
619.238.2111 | hughsteam@hugesmarino.com

HUGHESMARINO

LOCATION HIGHLIGHTS



**TRANSIT
SCORE**

84

**WALK
SCORE**

97

KEY HIGHLIGHTS

- Seamless access to major freeways and public transportation
- Walking distance to gourmet dining and many of San Diego's finest luxury boutique hotels
- 24 hour access

110 WEST A STREET, SUITE 1200



STAR HUGHES-GORUP | Senior Vice President & Director
619.238.2111 | hughesteam@hugesmarino.com

110 WEST A STREET, SUITE 1200



STAR HUGHES-GORUP | Senior Vice President & Director
619.238.2111 | hughes@hugesmarino.com

110 WEST A STREET, SUITE 1200



STAR HUGHES-GORUP | Senior Vice President & Director
619.238.2111 | hughsteam@hugesmarino.com

HUGHESMARINO

110 WEST A STREET, SUITE 1200



STAR HUGHES-GORUP | Senior Vice President & Director
619.238.2111 | hughsteam@hugesmarino.com

CONTACT INFORMATION

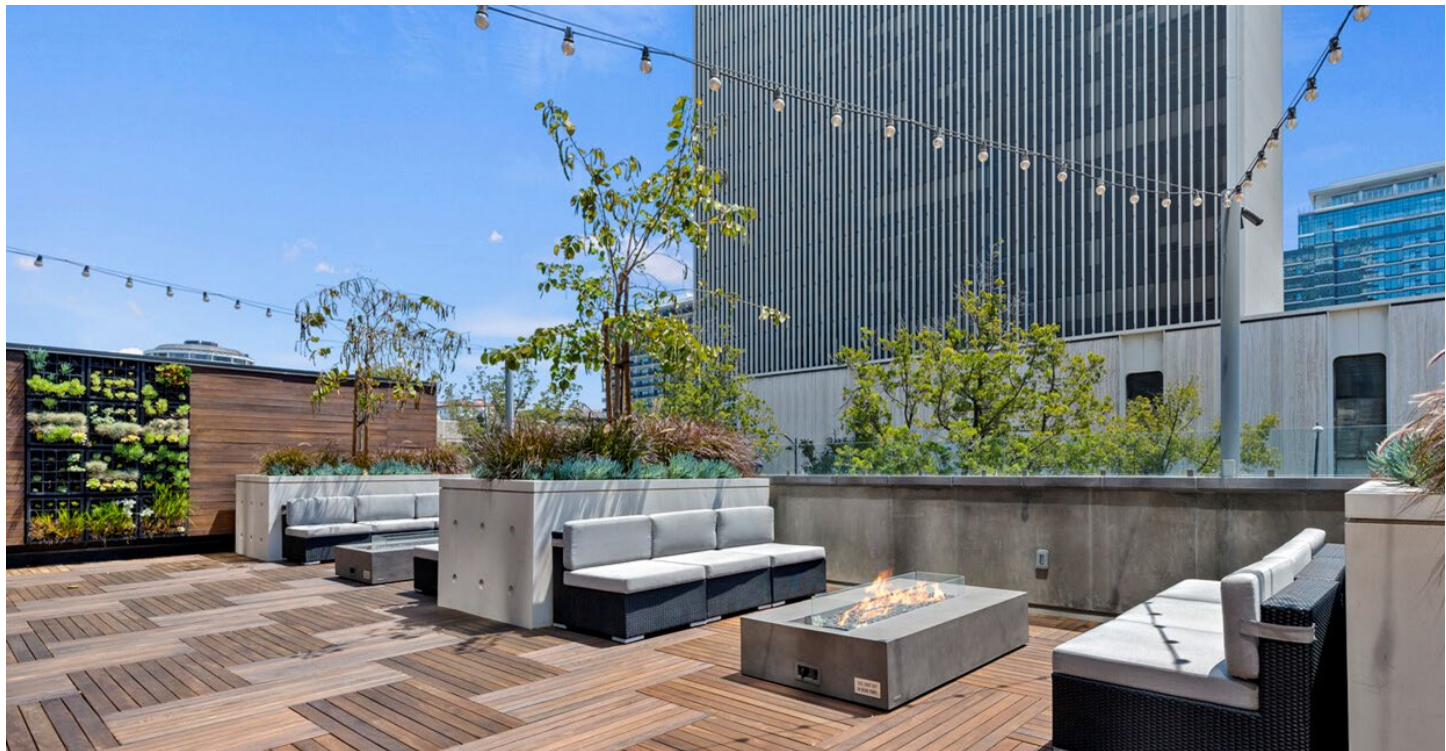

STAR HUGHES-GORUP

hughsteam@hughesmarino.com

619.238.2111

Broker Lic. #01907998

1450 FRONT STREET, SAN DIEGO, CA 92101

619.238.2111 | hughesmarino.com

HUGHESMARINO