

# 1655 GRANT STREET

CONCORD, CA 94520



HIGH-END TOP FLOOR OFFICE SUBLEASE | AVAILABLE NOW  
24,408 RSF

**KAM SCHROEDER**

Senior Vice President

925.984.6645 | kam@hughesmarino.com

**KEVIN BRENNAN**

Executive Vice President

415.431.3211 | kevin@hughesmarino.com

**HUGHES MARINO**

# BUILDING INFORMATION



## **ADDRESS**

1655 Grant Street, 13<sup>th</sup>  
Floor, Concord, CA 94520

## **AVAILABLE**

24,408 RSF

## **ASKING RATE**

Call for Rate

## **AVAILABLE THROUGH**

December 31<sup>st</sup>, 2026

## **SPACE FEATURES**

- Class A office sublease with high-end build-out with creative finishes
- Top-Floor space with incredible natural light
- 360-degree unobstructed view corridors
- Control of entire floor provides secure access
- Efficient layout that can accommodate required distancing measure
- Project includes abundant parking
- Full time property management, 24-hour security, day porters, and engineering staff

### **KAM SCHROEDER**

Senior Vice President

925.984.6645 | kam@hughesmarino.com

### **KEVIN BRENNAN**

Executive Vice President

415.431.3211 | kevin@hughesmarino.com

**HUGHES MARINO**

# LOCATION HIGHLIGHTS



WALK  
SCORE

91

FREEWAY  
ACCESS



RETAIL &  
RESTAURANTS



## KEY HIGHLIGHTS

- One block from Todos Santos Plaza, the building park offers tenants convenient access to Downtown Concord's extensive shopping, dining, and business services
- Directly adjacent to Concord BART Station
- Easy access to Interstate 680 and Highway 242 with proximity to Highway 4 to East County and Highway 24 to San Francisco,
- On-site amenities include a large full-service restaurant, convenience cafe offering to-go food and full-service cafe, a conference center, gym, and ATM machines.

**KAM SCHROEDER**

Senior Vice President  
925.984.6645 | kam@hughesmarino.com

**KEVIN BRENNAN**

Executive Vice President  
415.431.3211 | kevin@hughesmarino.com

**HUGHESMARINO**







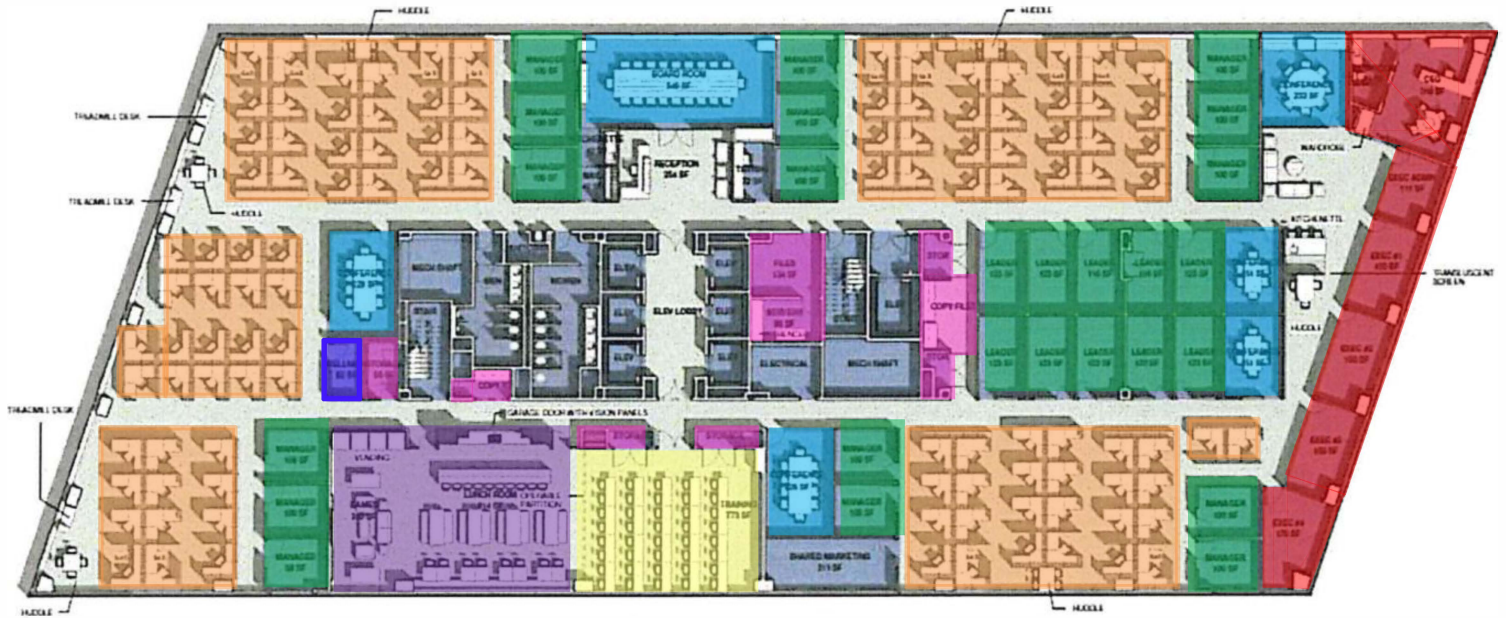



# FLOOR PLAN

## 13<sup>th</sup> FLOOR | 24,408 RSF



### SPACE HIGHLIGHTS

- Boardroom
- 2 Large conference rooms
- 3 Medium conference rooms
- Mix of private and open seating with capacity to seat 135+
- 5 Large glass-lined executive offices
- Large corner CEO office that includes private restroom
- Training room
- Reception area
- Multiple huddle rooms
- Large open kitchen with high-end finishes
- Copy room
- Mother's Room

-  105+ Workstations
-  26 Manager Offices
-  6 Executive Offices
-  Boardroom/Conference Rooms
-  Kitchen
-  Copy/File & Storage
-  Training Room
-  Mother's Room

**KAM SCHROEDER**

Senior Vice President

925.984.6645 | kam@hughesmarino.com

**KEVIN BRENNAN**

Executive Vice President

415.431.3211 | kevin@hughesmarino.com

**HUGHESMARINO**

1655 GRANT STREET, 13<sup>TH</sup> FLOOR



**KAM SCHROEDER**

Senior Vice President

925.984.6645 | kam@hughesmarino.com

**KEVIN BRENNAN**

Executive Vice President

415.431.3211 | kevin@hughesmarino.com

**HUGHESMARINO**



1655 GRANT STREET, 13<sup>TH</sup> FLOOR



**KAM SCHROEDER**

Senior Vice President

925.984.6645 | kam@hughesmarino.com

**KEVIN BRENNAN**

Executive Vice President

415.431.3211 | kevin@hughesmarino.com

**HUGHESMARINO**



# CONTACT INFORMATION



**KAM SCHROEDER**  
kam@hughesmarino.com  
925.984.6645  
Lic. #01722302



**KEVIN BRENNAN**  
kevin@hughesmarino.com  
415.431.3211  
Lic. #01127168

**ONE CALIFORNIA STREET, SUITE 1650**  
**SAN FRANCISCO, CA 94111**  
415.431.3211 | hughesmarino.com

**HUGHESMARINO**