

# 5405 Morehouse Drive San Diego CA

## Offices for Sublease in a New Suite



**Professional offices available to sublease** in a new suite for psychologists and related professionals who are looking for an office in a collegial suite. There are full-, and part-time opportunities in windowed and interior offices. The large 190 square foot interior office is available at a deeply discounted rate.

The spacious, modern, well-appointed suite includes *professional grade sound-proofing*, a *waiting room* with a *notification light system*, *reception area*, *kitchen*, and *storage area*. There is a *locking door that separates the waiting room from the offices*. Rent is all-inclusive.

- Highly desirable Class A courtyard style building with windowed offices.
- Extensive sound proofing
- Notification light system
- Free: utilities, high-speed Wi-Fi, bottled water, coffee & tea, kitchen supplies, janitorial, storage, parking
- Full & part-time opportunities



**This prime office location** is conveniently located among the surrounding communities of La Jolla, Carmel Valley, Scripps Ranch, Del Mar, Torrey Pines, Rancho Bernardo, Rancho Penasquitos, and Rancho Santa Fe.

One of the top courtyard buildings in the area, it features stunning contemporary restrooms, a beautiful main entrance lobby, a water fountain courtyard surrounded by a peaceful garden seating area.

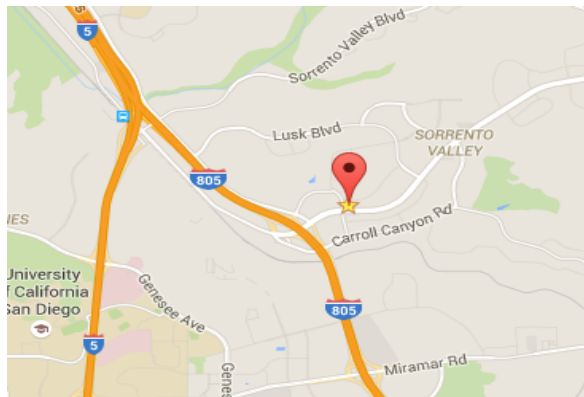
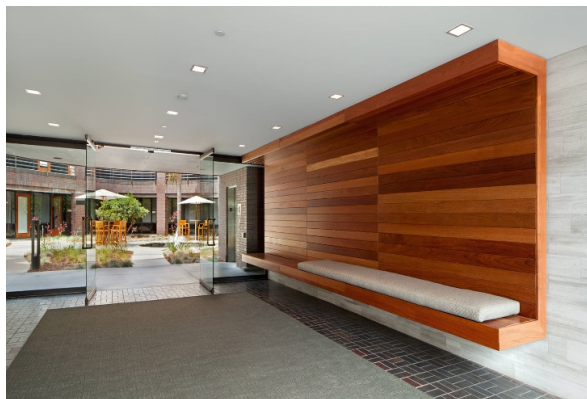

**This is an exceptional opportunity** to start a new, or build an existing private practice in a highly desirable area with a low density of mental health providers. The surrounding area includes a high SES community and the San Diego Tech Center, including Qualcomm and many other established tech companies.

**The People** People are what really make any suite special. I've shared multiple office spaces and have found that there are certain qualities that people bring to make the most comfortable and successful office spaces. Honesty, respect, ethics, an easy-going nature, mutual commitment to the space, assertiveness, and collegiality are a few of those qualities I'm looking for in office mates.

If you fit the bill, contact me as soon as possible to take advantage of discounts and referral fees!

**FOR MORE INFORMATION CONTACT:**

**Carrie Jaffe, PhD (858)208-9689**

**[cjaffephd@sbcglobal.net](mailto:cjaffephd@sbcglobal.net)**